

# Truck Routes & Seasonal Load Restrictions

Reminder

West Portage Avenue is NOT an approved truck route.  
East Easterday Ave is NOT an approved truck route. It is open to  
NON-COMMERICAL traffic until the project is complete in 2024.

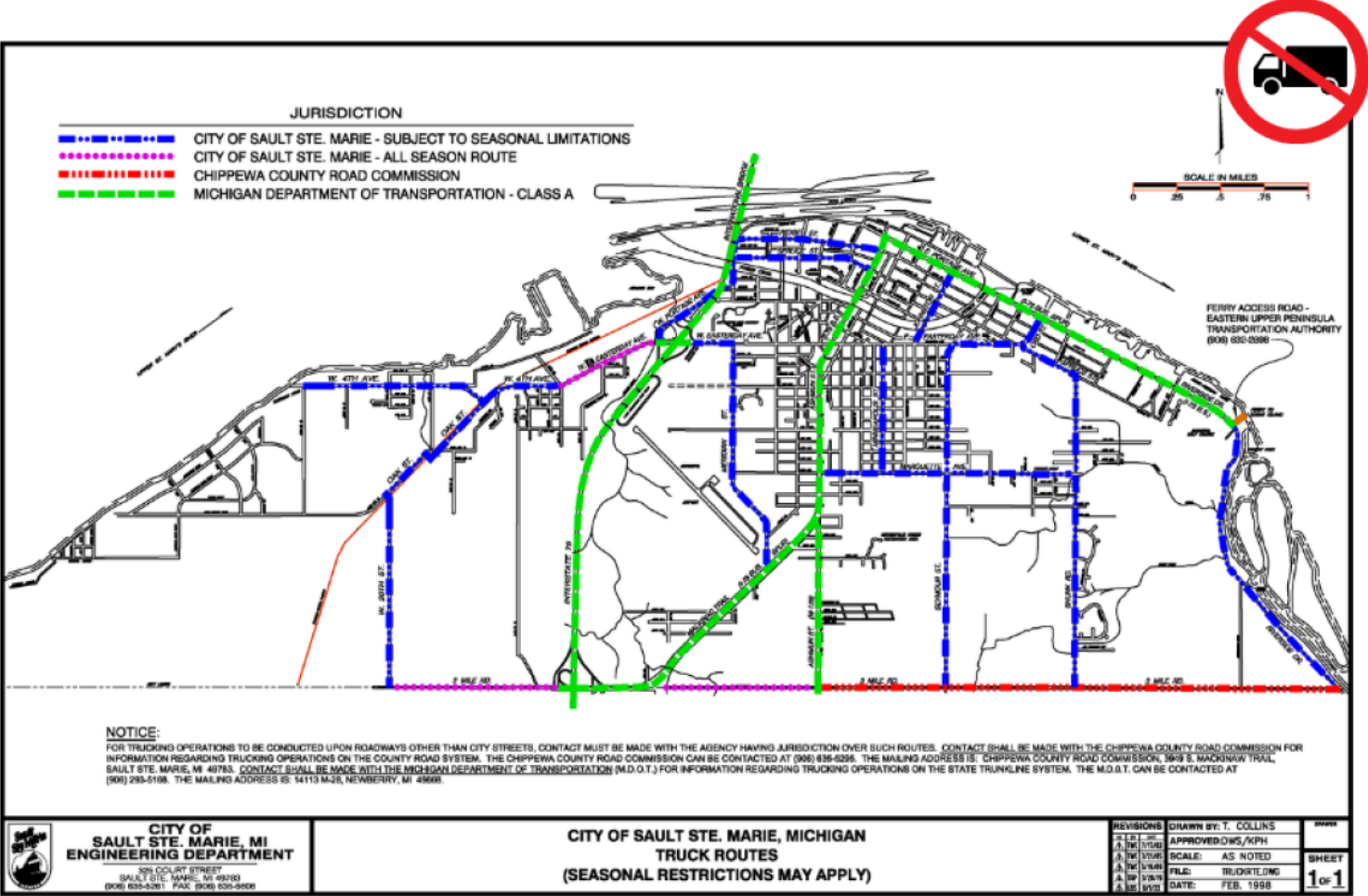

The Max weight limit on Truck routes is 80,000 gross lbs, unless posted otherwise.  
For more information on weight restrictions please contact the Engineering  
Department.

Transport Permit Fees	
Individual Oversize	\$30.00*

Individual Oversize / Overweight	\$200.00
Annual Oversize	\$100.00*
Overweight During Frost Restrictions (one delivery)	\$400.00
Overweight During Frost Restrictions (Seasonal)	\$600.00
Administration / Investigation Fee for Transporting Overweight or Oversize without a permit	\$500.00 plus damages

\*Plus costs incurred by the City for labor, equipment & materials as applicable.

[Click here for PDF version of Truck Route.](#)